



Ocean Endeavour



Ocean Endeavour is a modern expedition vessel expertly engineered to explore the Polar Regions. With an 1A ice-strengthened hull advanced navigation equipment and external stabilisers, she offers a comfortable and stable cruising experience, meanwhile providing opportunities to get closer any potential wilderness action.

The cabins and public areas are of a contemporary design, providing a bright and spacious feel. There is a 360° observation lounge with large windows, perfect for wildlife spotting. She offers guests an excellent voyage experience, with the choice of two restaurants, sundeck, ample deck space for observing the polar landscapes and lounges perfect for presentations and group meetings.

She is currently the only polar adventure ship in Antarctica with a large focus on health and wellness. Amenities include newly built saunas, pool, gym, hot tub, spa service and wellness cafe with juice bar.

There is a wide choice of cabin categories to choose from, suited to single travellers, couples and groups. With 25 single cabins, *Ocean Endeavour* is a great choice for single travellers, especially since there is no single supplement applied for single occupancy porthole cabins. Single travellers wishing to share a cabin can benefit from their own private bathroom facilities.

With the capacity for 199 passengers, all guests will be catered for throughout the voyage. Whilst the International Association of Antarctic Tour Operators (IAATO) dictates that groups of no more than 100 people are permitted ashore at any one time, guests onboard *Ocean Endeavour* need not be concerned. Whilst some groups will be enjoying guided trekking onshore, others will be kayaking, zodiac cruising or paddle boarding.



SPECIALISTS IN WILDERNESS & WILDLIFE TRAVEL WHERE LAND MEETS WATER

Tel: + 44 (0) 1428 620012

www.aqua-firma.com

Copyright Aqua-Firma Worldwide Ltd.

AQUA-FIRMA



- Triple
- Single
- Twin Porthole
- Twin Porthole Plus 1
- Twin Porthole Plus 2
- Twin Window
- Twin Window Plus 1
- Twin Window Plus 2
- Upper Deck Twin
- Superior Twin
- Top Deck Twin
- Junior Suite
- Owner's Suite

DECK PLAN

Yoga room
Deck 9



Spa, sauna
& gym
Deck 8

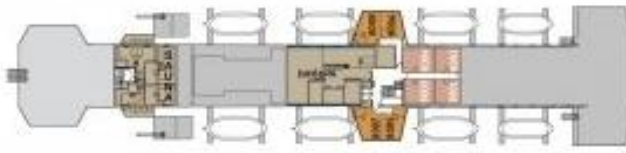

Hot tub
Deck 7



Wellness Café
& Pool
Deck 6



Deck 5

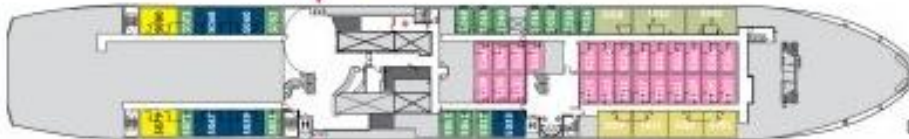

Deck 4



Pool



Gym

AQUA-FIRMA

SPECIALISTS IN WILDERNESS & WILDLIFE TRAVEL WHERE LAND MEETS WATER

Tel: + 44 (0) 1428 620012

www.aqua-firma.com

Copyright Aqua-Firma Worldwide Ltd.

Cabins



Twin Porthole



Twin Window



Top Deck Double



Superior Double



Superior Twin



Owner's Suite

AQUA-FIRMA

Life Onboard



Dining Rooms



Club Lounge



Sauna



Nautilus Lounge



AQUA-FIRMA

SPECIALISTS IN WILDERNESS & WILDLIFE TRAVEL WHERE LAND MEETS WATER

Tel: + 44 (0) 1428 620012

www.aqua-firma.com

Copyright Aqua-Firma Worldwide Ltd.



Features

Cabins	Aboard	Activities
<ul style="list-style-type: none"> • Electrical Supply: 220 volts, 50 Hz. • Private bathroom facilities • Radio • TV 	<ul style="list-style-type: none"> • Two restaurants • Nautical lounge • Polar library • Gym • Newly built saunas and spa facilities • Wellness café • Lecture Theatre • Polar Boutique • Sundeck and plenty of deck space for observation 	<ul style="list-style-type: none"> • Snowshoeing (included) • Zodiac Cruising (included) • Kayaking (additional charge) • Stand-up Paddleboarding (additional charge) • Camping (additional charge)

Specifications

Capacity:	199 passengers
Registration:	Marshall Islands
Length:	137 metres
Draft:	5.6 metres
Ice Class:	1B
Cruising Speed:	15 knots
Staff & Crew:	124
Safety Equipment:	6 lifeboats

Committed to Nature:



SPECIALISTS IN WILDERNESS & WILDLIFE TRAVEL WHERE LAND MEETS WATER

Tel: + 44 (0) 1428 620012

www.aqua-firma.com

Copyright Aqua-Firma Worldwide Ltd.