

AQUA-FIRMA

M/V Janssonius



M/V *Janssonius* is the most structurally and technologically advanced class of polar cruise ship to date. Equipped with stabilizers, she is suitable for advanced, innovative exploratory voyages in the Arctic and Antarctic regions. She has been designed from the ground up for rapid response to weather and wildlife conditions that exist nowhere else in the world. This expedition vessel not only meets the challenges of the polar regions, but optimizes their opportunities for adventure.

With her ice-strengthened Polar Class 6 technology, she exceeds the current high standards of the International Maritime Organization. Using only bio-degradable paints, LED lighting, steam heat and flexible power management systems to keep fuel consumption and CO² emission at the absolute minimum.

Despite being designed to navigate through the least civilised locations on earth, the on-board experience is far from uncivilised. With high quality cuisine, comfortable surroundings and service that starkly contrasts the rugged world outside the window. There is a sizeable observation lounge, separate lecture room, well stocked bar and library. There is also plentiful outside deck space for wildlife observations.

Two separate gangways facilitate speedier zodiac boarding, meanwhile there is also an indoor platform which can be used for specialist outdoor activities like kayaking and scuba diving.

Cabins are all custom designed, spacious and tastefully decorated with stylish mid-century décor.

Committed to Nature



 **AQUA-FIRMA**

SPECIALISTS IN WILDERNESS & WILDLIFE TRAVEL WHERE LAND MEETS WATER

Tel: + 44 (0) 1428 620012

www.aqua-firma.com

Copyright Aqua-Firma Worldwide Ltd.

Deck Plan

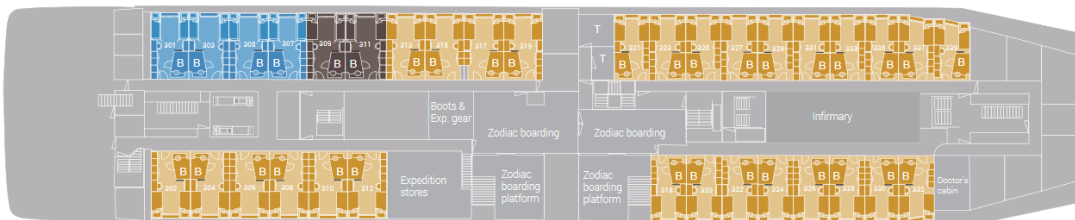
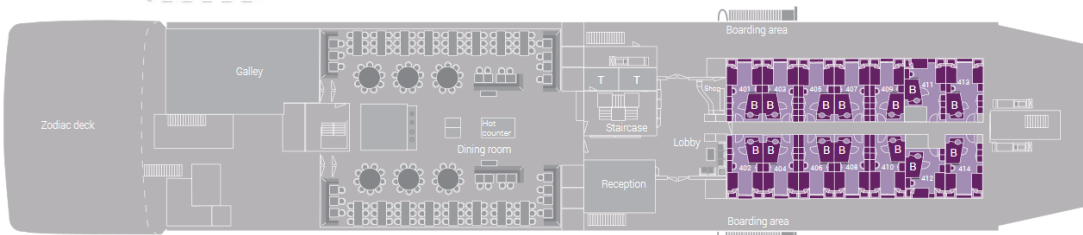
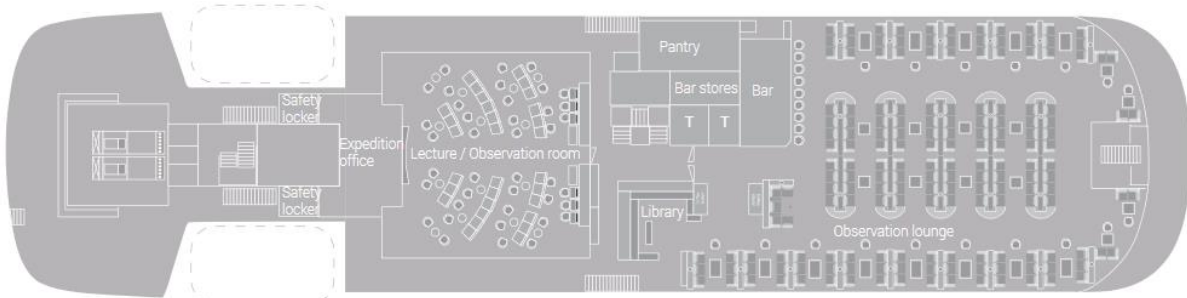
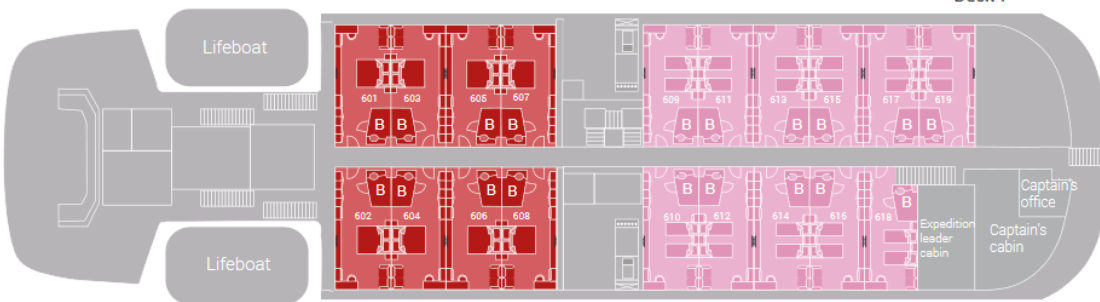
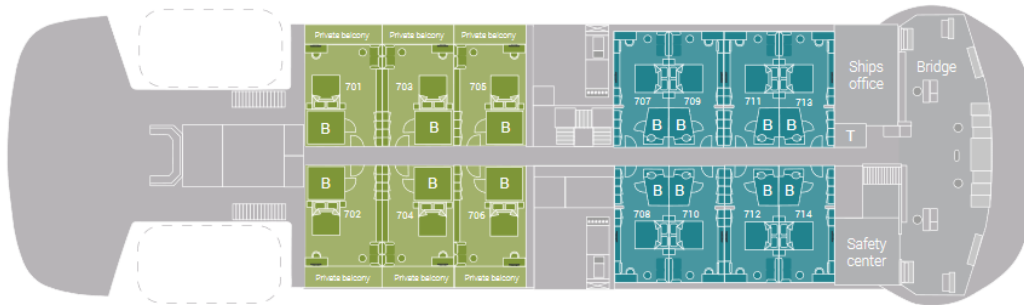

m/v Hondius deck plan Oceanwide Expeditions			
Grand Suite with private balcony	Twin Window	Upper / lower berths	Double bed
Junior Suite	Twin Porthole	Lower berths	Toilet
Superior	Triple Porthole	2 separate lower berths	Bathroom
Twin deluxe	Quadruple Porthole		

AQUA-FIRMA



Library



Dining Room



Observation Lounge



Janssonius Bow



Lecture Theatre



Lobby / gift Shop



Observation Lounge



Bar Area

AQUA-FIRMA

SPECIALISTS IN WILDERNESS & WILDLIFE TRAVEL WHERE LAND MEETS WATER

Tel: + 44 (0) 1428 620012

www.aqua-firma.com

Copyright Aqua-Firma Worldwide Ltd.

AQUA-FIRMA

Grand Suite (6 Cabins @ 27 metres² with balcony)



Junior Suite (8 Cabins @ 19 - 20 metres²)



Superior Cabin (8 Cabins @ 20 - 21 metres²)



AQUA-FIRMA

SPECIALISTS IN WILDERNESS & WILDLIFE TRAVEL WHERE LAND MEETS WATER

Tel: + 44 (0) 1428 620012

www.aqua-firma.com

Copyright Aqua-Firma Worldwide Ltd.

AQUA-FIRMA

Twin Deluxe Cabin (11 Cabins @ 19 – 21 metres²)



Twin Window (14 cabins @ 12 – 14 metres²)



Twin Porthole (27 Cabins @ 12 – 18 metres²)



AQUA-FIRMA

SPECIALISTS IN WILDERNESS & WILDLIFE TRAVEL WHERE LAND MEETS WATER

Tel: + 44 (0) 1428 620012

www.aqua-firma.com

Copyright Aqua-Firma Worldwide Ltd.

Triple Porthole (2 Cabins @ 12 – 18 metres²)



Quadruple Porthole (4 Cabins @ 12 – 18 metres²)



Specifications:

Registered:	The Netherlands
Length:	107.6 metres
Breadth:	17.6 metres
Draft:	5.3 metres
Ice Class:	Polar Class 6 (equivalent 1A-Super)
Displacement:	5,590 tonnes
Propulsion:	2 x ABC main engines; total 4,200 kw
Speed:	15 knots
Passengers:	170 in 80 Cabins
Staff & Crew:	72
New Build:	2020